



SWIFT
CREATING SMILES FOR LIFE

Make your staycation a

safe-cation

*Love
Holiday
Homes*

2021 HOLIDAY HOME RANGE



HOLIDAY HOME RANGE

At Swift we want your holiday home to be your sanctuary, where you can relax, unwind and let the 9-5 melt away. That's why everything we produce is designed for the utmost luxury and practicality, using our innovative approach to help you create smiles for life. Step inside and take the tour...

CONTENTS

- | | | | |
|----|----------------------------|----|-------------------------------|
| 04 | SWIFT SUPERIOR STANDARD | 26 | LOIRE |
| 06 | VENDEE | 30 | ARDENNES |
| 10 | ANTIBES | 34 | HOLIDAY HOMES AT A GLANCE |
| 14 | BORDEAUX / BORDEAUX ESCAPE | 36 | THE SWIFT DIFFERENCE |
| 18 | BIARRITZ | 38 | HOLIDAY HOME DIMENSIONS |
| 22 | BURGUNDY | 40 | FINISHES AND SOFT FURNISHINGS |



SWIFT SUPERIOR STANDARD

There's no better feeling than stepping into your holiday home for a relaxing getaway, so we do everything possible to make that feeling last for years to come.

We pride ourselves on applying superior manufacturing quality to everything we produce, giving you the confidence that your investment is protected and built to last. With the comfort of total assurance in your purchase, you can get on with the important things in life – making smiles and enjoying unforgettable getaways.

And prioritising your peace of mind, we offer outstanding warranties, including a 3-year Manufacturer Supersure Warranty, 5-year Structural Warranty and 10-year Chassis Warranty.



EXCLUSIVE DUVALAY™ MATTRESSES

All beds feature indulgent Duvalay™ mattresses for the best nights' sleep possible



STAIN RESISTANT CARPETS

With stain resistant carpets, there's no need to waste your precious holiday time scrubbing



BONDED EXTERIOR WALLS

'Sandwich' construction walls provide a more rigid exterior, bonded with insulation in the middle



FULLY GALVANISED CHASSIS

A fully galvanised chassis, warranted for 10 years



ELECTRICAL AND USB SOCKETS

Stay connected with electrical and USB sockets in selected areas keeping everything charged

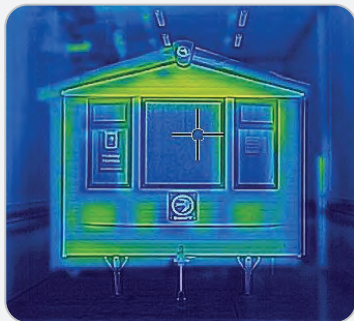

CHAMBER TESTING

Enjoy outstanding thermal efficiency, proven by thorough environmental chamber testing

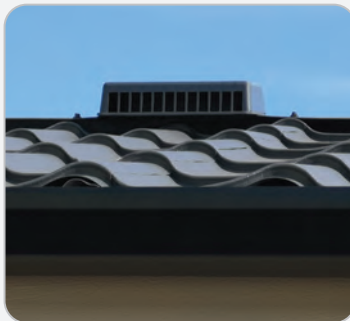

EXTERNALLY VENTED EXTRACTORS

Keep your holiday home fresh and dry with externally vented extractors, preventing damp and odours



INTEGRATED MICROWAVES

Optimising valuable work surface space, all Swift holiday homes feature integrated microwaves



INTEGRATED FRIDGE FREEZERS

Integrated fridge freezers are included across all ranges to maintain a sleek, uncluttered look (except 10ft-wide models)



LED CEILING LIGHTS

Benefiting the environment and your pocket, bright, low energy LED lighting is included throughout





Vendee Holiday Home is an elegant country retreat which blends rural character with modern design and plenty of space for the whole family. Enjoy the finer things in life with this high specification range, where luxurious details and ample storage combine with stunning aesthetics to create a warm, peaceful holiday home you'll look forward to visiting again and again.

Model size	Bedrooms	Double	Twin
40' x 12'	2	2.02m x 1.53m (6'8" x 5'0")	1.90m x 0.75m (6'3" x 2'6")

VENDEE FEATURES

Along with the Swift Superior Standard (see page 4), Vendee also comes with many desirable extras including:



Double Glazing



Central Heating Boiler



Cooker



Electric Fire



Wardrobe





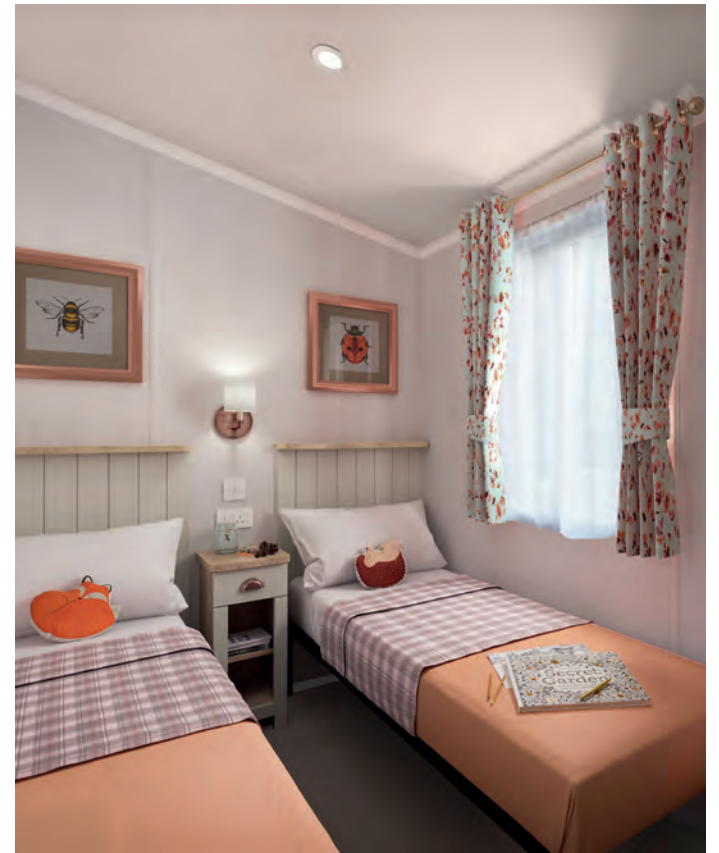

FEATURES

EXTERIOR

- Fusion galvanised chassis with finish warranted for 10 years
- Bonded 'sandwich' exterior wall construction for greater strength
- Coated steel pantile roof
- Distinctive pre-coated 'folded' steel bargeboards with LED lighting to front aspect
- Woodgrain textured 'Sandy Beige' aluminium cladding
- 'Front Aspect' French doors
- uPVC windows with push-button security locks
- PVC gutters and down pipes
- Low energy exterior side lighting

INSULATION

- Excellent thermal performance:
 - Thermaglas uPVC double glazed windows & doors
 - 50mm insulation in floor
 - 90mm insulation in roof
 - 30mm insulation in walls
 - Lagged underfloor pipes

INTERIOR

- 'Amalfi' soft furnishing scheme
- Condensing gas combi-boiler central heating and hot water system with radiator thermostat
- Luxury carpet with underlay throughout
- Hardwearing vinyl flooring in Almeria in kitchen/dining/bathroom(s)
- Low energy LED lighting throughout
- Nebraska Oak woodgrain
- Good provision of double electric sockets throughout
- Freestanding two-seater and three-seater sofas with scatter cushions
- Complementary footstool with storage
- Contemporary 2kW electric Optiflame® stove feature fire with mirror over fireplace
- TV unit with storage, TV provision and Sky TV cable for connection only to TV cabinet
- White slatted wooden blinds
- Full height luxury curtains to front aspect
- Contemporary framed colour wall pictures
- Central Tyler copper effect pendant light feature
- USB sockets

HALLWAY

- Seat bench featuring coat hooks and shoe storage
- Large mirror and wall unit

KITCHEN / DINING

- Belling stainless steel oven
- Integrated silver extractor hood vented to outside
- 5-burner gas hob with electronic ignition
- Brown 'Mountain Larch' splashbacks
- Integrated microwave oven with digital controls (800w)
- Double door integrated fridge freezer
- White resin bowl and drainer with copper effect tap
- 40mm Brown 'Mountain Larch' laminate worktops
- Kitchen with country classic feel. Cupboards in 'Dakar' with Larch woodgrain details and metallic cup door and drawer handles
- Soft close drawers
- Integrated wine rack
- 'Florence' dining table in 'Nebraska Oak'/'Painted Porcelain' with four Combo chairs

BATHROOM(S)

- Shower cubicle with thermostatic shower, topper and LED downlights in main bathroom and ensuite
- Dual flush WC with soft close toilet seat
- Vanity storage unit with mirror above
- Additional storage cupboard
- Extractor fan
- White heated towel rail

BEDROOMS

- King-size double bed in main bedroom with lift up storage
- Duvalay™ mattress to all beds with Crib 5 rated fabric
- Padded headboard in main bedroom
- Wall mounted bedside lights
- Ample storage with bedside units and over bed cupboards in the main bedroom
- Dressing table with mirror, lighting and storage
- Window seat and TV panel with credenza in main bedroom
- Nature inspired wall picture(s)
- TV sockets and Co-Ax to all bedrooms plus booster

OPTIONS

- Environmental exterior
- Wireless programmable room thermostat
- 'SwiftShield' stain-resistant fabric
- Shaving socket in main bathroom
- Dishwasher or washing machine
- Bluetooth audio connection to lounge ceiling speakers
- Premium comfort 22" high queen-size airbed for additional sleeping space with built-in electric pump

FLOORPLANS



40' x 12' - 2 Bedroom



Chic and sophisticated, the Antibes Holiday Home has an architectural exterior and an open plan living area infused with touches of modern design, crafting a welcoming ambiance that melds with the excellent level of standard specification to create a highly desirable home from home.

ANTIBES FEATURES

Along with the Swift Superior Standard (see page 4), Antibes also comes with many desirable extras including:

Model size	Bedrooms	Double	Twin	Rear Twin	Sofa bed
39' x 12'	2	1.91m x 1.53m (6'3" x 5'0")	1.83m x 0.69m (6'0" x 2'3")	N/A	1.80m x 1.12m (5'11" x 3'8")
40' x 12'	3	1.91m x 1.37m (6'3" x 4'6")	1.83m x 0.69m (6'0" x 2'3")	1.83m x 0.69m (6'0" x 2'3")	1.80m x 1.12m (5'11" x 3'8")



Sofa Bed



TV Point



Cooker



Wardrobe







FEATURES

EXTERIOR

- Fusion galvanised chassis with finish warrantied for 10 years
- Bonded sandwich exterior wall construction for greater strength
- Coated steel pantile roof
- Distinctive 'folded' steel bargeboards
- Architectural front design
- 'Sandy Beige' woodgrain textured aluminium cladding
- uPVC windows with push-button security locks
- PVC gutters and down pipes
- Low energy exterior light

INSULATION

- Excellent thermal performance:
 - 50mm insulation in floor
 - 90mm insulation in roof
 - 30mm insulation in walls
 - Lagged underfloor pipes

INTERIOR

- 7ft (2.13m) high ceilings at side walls
- 'Ibiza' soft furnishings
- Gas water heater
- Luxury carpet with underlay throughout
- Laminate effect vinyl flooring in kitchen/dining/bathroom(s)
- Low energy LED lighting throughout
- Modern planked ceiling system gives a smoother finish with only one central seam
- 'Tisano Oak' woodgrain
- Curtains and voiles throughout
- USB sockets
- Good provision of double electric sockets throughout

*Design may change mid-season, check with your dealer when ordering.

LOUNGE

- Freestanding L-shaped sofa with fold out occasional bed and scatter cushions
- TV area with feature wall, provision for flat screen TV (up to 40') and Sky TV cable for connection only, LED lighting and storage
- Bookshelf between lounge and dinette
- Decorative feature wall behind TV space*
- Two cube stools stored under coffee table
- Framed wall picture
- Wall mirror

KITCHEN / DINING

- Streamlined kitchen units with handleless doors
- Thetford 'Cocina' glass fronted oven, grill and electronic ignition with improved door function, higher temperatures, burner rating and heat up times
- Black designer angled glass cooker hood with extractor fan vented to outside
- 4-burner gas hob with electronic ignition
- Black glass oven splashback/heat shield
- Integrated microwave oven with digital controls (800w)*
- Double door integrated fridge freezer
- 1½ bowl stainless steel sink/drainer
- 'Lava' acrylic splashbacks
- 40mm laminate worktops with matching upstands
- Under cupboard worktop feature lighting
- Stylish wood finish dining table with bench and two chairs
- Double width window with roller blinds

BATHROOM(S)

- 'Windermere' shower cubicle with thermostatic shower mixer, ceramic tiled feature and LED downlight in main bathroom and en suite (39' x 12' only)
- Dual flush WC with soft close toilet seat
- Extractor fan in bathroom and en-suite
- 'Ocean Drive' feature panel over vanity with LED lighting

BEDROOMS

- King-size double bed in main bedroom with lift up storage (4'6" in 3 bed models) and feature panel above headboard
- Duvalay™ mattress to all beds with Crib 5 rated fabric
- Padded headboard(s)
- Reading lights
- Ample storage with bedside units and over bed lockers with LED feature lighting
- Vanity area with LED illuminated mirror and socket
- 'Loft' style feature panel in twin bedroom(s)
- TV sockets & Co-Ax to all bedrooms plus booster

OPTIONS

- 'Thermaglas' uPVC double glazing in Anthracite
- Sliding 'Front Aspect' patio doors
- Environmental exterior with Anthracite windows
- Condensing gas combi-boiler central heating and hot water system:
 - Radiator thermostats
 - White towel radiator in shower rooms
 - Wireless programmable room thermostat with gas central heating
- 'SwiftShield' stain resistant fabric
- Shaving socket in bathroom
- Integrated dishwasher or washing machine
- Bluetooth audio connection to lounge ceiling speakers

FLOORPLANS



39' x 12' - 2 Bedroom

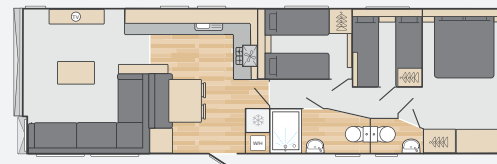

40' x 12' - 3 Bedroom



Bonded wall construction



Integrated 5ft deck with balustrade (Escape)

Well-appointed and stylish, the contemporary, practical accommodation comes with a choice of two or three bedrooms. With an elegant and welcoming design, conjured by the 'Maldives' soft furnishing scheme, this holiday home offers exceptional value for money as well as a homely feel.

Model size	Bedrooms	Double	Twin	Rear Twin	Sofa bed
33' x 12'	2	1.91m x 1.37m (6'3" x 4'6")	1.83m x 0.69m (6'0" x 2'3")	N/A	1.80m x 1.12m (5'11" x 3'8")
35' x 12'	2	1.91m x 1.53m (6'3" x 5'0")	1.83m x 0.69m (6'0" x 2'3")	N/A	1.80m x 1.12m (5'11" x 3'8")
38' x 12'	2	1.91m x 1.53m (6'3" x 5'0")	1.83m x 0.69m (6'0" x 2'3")	N/A	1.80m x 1.12m (5'11" x 3'8")
38' x 12' ES	2	1.91m x 1.53m (6'3" x 5'0")	1.83m x 0.69m (6'0" x 2'3")	N/A	1.80m x 1.12m (5'11" x 3'8")
38' x 12'	3	1.91m x 1.37m (6'3" x 4'6")	1.83m x 0.69m (6'0" x 2'3")	1.83m x 0.61m (6'0" x 2'0")	1.80m x 1.12m (5'11" x 3'8")
Bordeaux Escape					
38' x 12'	2	1.91m x 1.37m (6'3" x 4'6")	1.83m x 0.69m (6'0" x 2'3")	N/A	1.80m x 1.12m (5'11" x 3'8")
41' x 12'	3	1.91m x 1.37m (6'3" x 4'6")	1.83m x 0.69m (6'0" x 2'3")	1.83m x 0.61m (6'0" x 2'0")	1.80m x 1.12m (5'11" x 3'8")

BORDEAUX AND BORDEAUX ESCAPE FEATURES

Along with the Swift Superior Standard (see page 4), Bordeaux and Bordeaux Escape also come with many desirable extras including:



Sofa Bed



TV Point



Cooker



Wardrobe



Electric Fire

Image shown is the Bordeaux Escape lounge



Contemporary electric fire

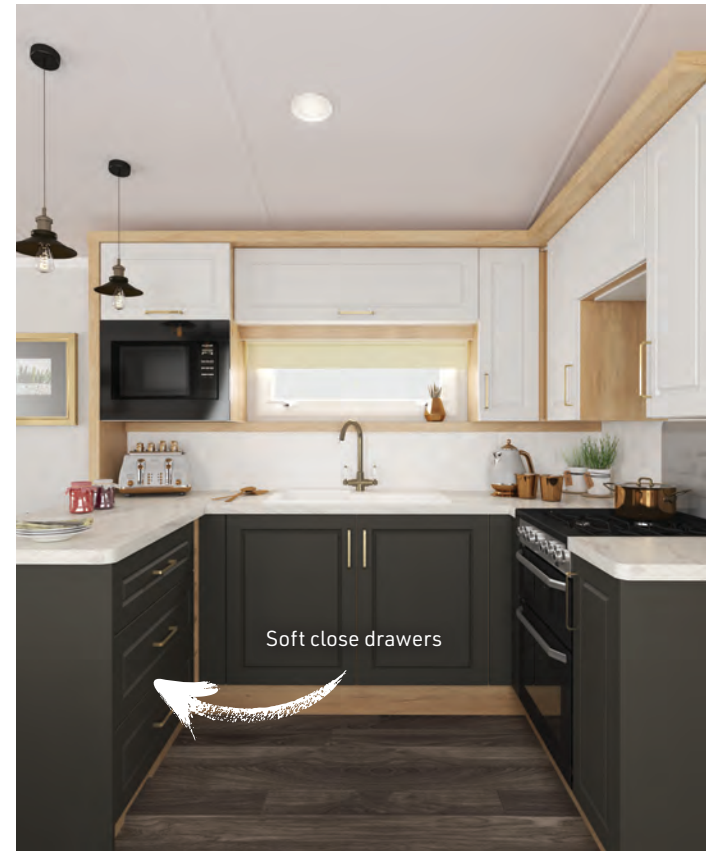

Soft close drawers



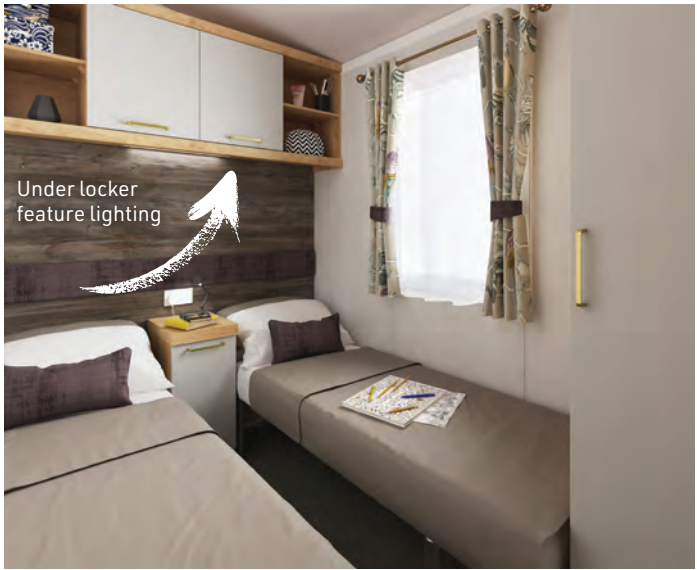

FEATURES

EXTERIOR

- Fusion galvanised chassis with finish warrantied for ten years
- Bonded sandwich exterior wall construction for greater strength
- Coated steel pantile roof
- Distinctive pre-coated 'folded' steel bargeboards with LED lighting to front aspect
- 'Sandy Beige' woodgrain textured aluminium cladding
- Covered integrated 5ft deck with balustrade (Bordeaux Escape)
- 'Front Aspect' sliding doors (Bordeaux Escape)
- uPVC 'Rustic Oak' windows with push-button security locks (Bordeaux Escape)
- White uPVC windows with push-button security locks (Bordeaux)
- PVC gutters and down pipes
- Low energy exterior side light

INSULATION

- Excellent thermal performance:
 - 50mm insulation in floor
 - 90mm insulation in roof
 - 30mm insulation in walls
 - Lagged underfloor pipes

INTERIOR

- 7ft (2.13m) high ceilings at side walls
- 'Maldives' soft furnishing scheme
- Planked interior ceiling system (Bordeaux Escape)
- Luxury carpet with underlay throughout
- Laminate effect vinyl flooring in kitchen/dining/bathroom(s)
- 'Nebraska Oak' woodgrain
- Stylish 'Pronto' gold matt handles throughout
- Low energy LED lighting throughout
- USB sockets
- Good provision of double electric sockets throughout

LOUNGE

- Freestanding two-piece suite with fold out occasional bed and scatter cushions
- Coffee table with two upholstered cylindrical stools underneath
- Framed fireplace with contemporary 'Bach' electric fire
- Mirror with gold frame
- Stylish framed wall picture
- TV point with Co-Ax and 240V socket

KITCHEN / DINING

- Soft close on kitchen units
- Thetford 'Cocina' glass fronted oven, grill and electronic ignition with improved door function, higher temperatures, burner rating and heat up times
- Discrete extractor fan vented to outside
- 4-burner gas hob with electronic ignition
- Integrated microwave
- Double door integrated fridge freezer
- White resin bowl and drainer
- Brass effect tap with porcelain handles
- 40mm 'Torano Marble' laminate worktops with upstands
- White tile effect splashback
- Stylish kitchen units in 'Riverstone' supermatt with upper doors in 'Light Grey' perfect touch
- Two 'Steam Punk' pendant light fittings above central worktop
- Dining suite with four 'Rochelle' chairs in 'Riverstone' (two additional folding chairs in three-bed models)
- Table comes with 'Toulouse' wood effect top
- Roller blind in 'Carnival Buttercup'

BATHROOM(S)

- Large shower cubicle with glass sliding door and thermostatic shower with topper in main bathroom
- LED vanity spotlights
- Dual flush WC
- Acrylic splashback with green glass look
- Extractor fan in main bathroom

BEDROOMS

- Double bed in main bedroom with lift up storage (king-size in 35'x12' 2B & 38'x12' 2B)
- Duvalay™ mattress to all beds with Crib 5 rated fabric
- Padded headboard(s)
- Under locker LED strip lights
- Bedside cabinets with 'Jackson Pine' inset panel and overbed storage
- Brass effect curtain poles
- Vanity area with mirror and socket in main bedroom
- TV sockets & Co-Ax to all bedrooms plus booster

OPTIONS

- Environmental exterior
- 'Thermaglas' uPVC double glazing
- 'Front Aspect' French doors (Bordeaux)
- Gas combi-boiler central heating and hot water system;
 - Radiator thermostats and radiator in en-suite
 - Towel radiator in main bathroom
- 'SwiftShield' stain resistant fabric
- Wireless programmable room thermostat with gas central heating
- Shaving socket in bathroom
- Bluetooth audio connection to lounge ceiling speakers
- Integrated slim-line dishwasher

FLOORPLANS

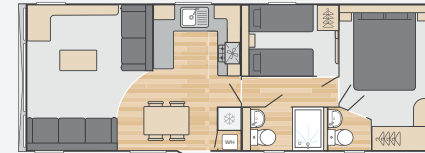

Bordeaux 33' x 12' - 2 Bedroom

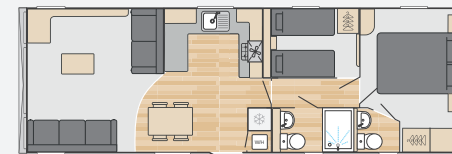

Bordeaux 35' x 12' - 2 Bedroom

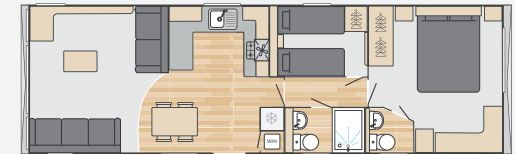

Bordeaux 38' x 12' - 2 Bedroom

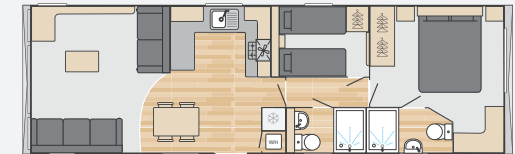

Bordeaux 38' x 12' - 2 Bedroom ES



Bordeaux 38' x 12' - 3 Bedroom



Bordeaux Escape 38' x 12' - 2 Bedroom

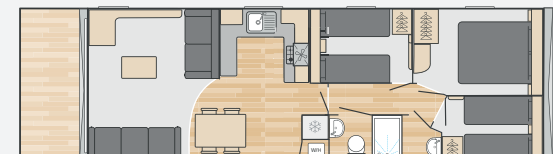

Bordeaux Escape 41' x 12' - 3 Bedroom



Fusion galvanised chassis



The Biarritz is an elegant, roomy and well-equipped holiday home that's an ideal choice for families. Luxury details enhance the hardwearing interior, with a distinctive kitchen design and soft furnishing scheme creating an inviting feel, and a range of two and three-bedroom layouts enabling you to select the model most suited to your needs.

Model size	Bedrooms	Double	Twin	Rear Twin	Sofa bed
35' x 12'	2	1.91m x 1.53m (6'3" x 5'0")	1.83m x 0.69m (6'0" x 2'3")	N/A	1.80m x 1.12m (5'11" x 3'8")
38' x 12'	2	1.91m x 1.53m (6'3" x 5'0")	1.83m x 0.69m (6'0" x 2'3")	N/A	1.80m x 1.12m (5'11" x 3'8")
38' x 12' ET	3	1.91m x 1.37m (6'3" x 4'6")	1.83m x 0.69m (6'0" x 2'3")	1.83m x 0.61m (6'0" x 2'0")	1.80m x 1.12m (5'11" x 3'8")

BIARRITZ FEATURES

Along with the Swift Superior Standard (see page 4), Biarritz comes with many desirable extras including:



Sofa Bed



TV Point



Cooker



Wardrobe







FEATURES

EXTERIOR

- Fusion galvanised chassis with finish warrantied for ten years
- Bonded sandwich exterior wall construction for greater strength
- Coated steel pantile roof
- Distinctive pre-coated 'folded' steel bargeboards with LED lighting to front aspect
- 'Sandy Beige' woodgrain textured aluminium cladding
- Full height front fixed window
- uPVC windows with push-button security locks
- PVC gutters and down pipes
- Low energy exterior side light

INSULATION

- Excellent thermal performance:
 - 50mm insulation in floor
 - 90mm insulation in roof
 - 30mm insulation in walls
 - Lagged underfloor pipes

INTERIOR

- 7ft (2.13m) side wall ceiling height
- 'Butterscotch' soft furnishing scheme
- Gas water heater
- Luxury carpet with underlay throughout
- Laminate effect vinyl flooring in kitchen/dining/bathroom(s)
- Cloakroom area with upholstered seat, shoe rack and mirror
- Low energy LED lighting throughout
- Modern 'Nebraska Oak' woodgrain
- USB double socket
- Good provision of double electric sockets throughout

LOUNGE

- Fixed L-shape sofa with fold out occasional bed
- Freestanding armchair (except 35' model)
- Feature coffee table
- Stylish mirror
- **NEW** half-height partition to create an open plan space between the lounge and kitchen
- TV point with Co-Ax and 240V socket

KITCHEN / DINING

- Thetford 'Cocina' glass fronted oven, grill and electronic ignition with improved door function, higher temperatures, burner rating and heat up times
- Stainless steel cooker hood with extractor fan vented outside
- 4-burner gas hob with electronic ignition
- Integrated microwave
- Full height integrated fridge freezer
- Stainless steel sink/drainer
- 'Metal Block' 40mm laminate worktops with matching upstands
- Distinctive kitchen doors in 'porcelain'
- Modern freestanding dining table and 'Rochelle' chairs (2 additional folding chairs in 3 bed model)

BATHROOM(S)

- Large shower cubicle with glass sliding door and thermostatic shower in main bathroom
- LED vanity spotlights
- Dual flush WC
- Acrylic splashback in green glass look
- Extractor fan in main bathroom

BEDROOMS

- King-size double bed in main bedroom with lift up storage (4'6" in 3 bed model)
- Duvalay™ mattress to all beds with Crib 5 rated fabric
- Under locker LED strip lights
- Bedside cabinets and overbed storage
- Vanity area with mirror and socket in main bedroom
- TV sockets & Co-Ax to all bedrooms plus booster

OPTIONS

- 'Thermaglas' uPVC double glazing
- 'Front Aspect' French doors - only on double glazed models
- Environmental exterior
- 'SwiftShield' stain resistant fabric
- Bluetooth audio connection to lounge ceiling speakers
- Full height partition with contemporary acrylic feature panel to create a separate lounge, and includes a modern wall picture
- Condensing gas combi-boiler central heating and hot water system;
 - Radiator thermostats
 - Radiator in en suite
- Wireless programmable room thermostat with gas central heating
- Contemporary electric fire
- Electric plinth heaters and towel rails
- Shaving socket in bathroom

FLOORPLANS

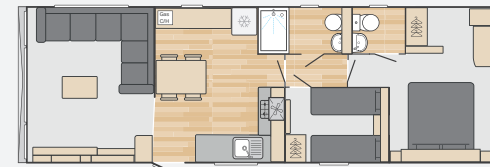

35' x 12' - 2 Bedroom



38' x 12' - 2 Bedroom



38' x 12' - 3 Bedroom ET



The Burgundy Holiday Home offers outstanding value while fusing practicality with timeless design for fantastic family accommodation. Available in a choice of two and three-bedroom layouts, including a **NEW** larger three bed layout for 2021, its versatile aspect is exceptionally appealing, and boasts a fresh 'Botanical' soft furnishings scheme.

Model size	Bedrooms	Double	Twin	Rear Twin	Sofa bed
29' x 12'	2	1.91m x 1.37m (6'3" x 4'6")	1.83m x 0.69m (6'0" x 2'3") 1.76m x 0.69m (5'9" x 2'3")	N/A	1.80m x 1.12m (5'11" x 3'8")
33' x 12'	2	1.91m x 1.37m (6'3" x 4'6")	1.83m x 0.69m (6'0" x 2'3") 1.76m x 0.69m (5'9" x 2'3")	N/A	1.80m x 1.12m (5'11" x 3'8")
36' x 12'	2	1.91m x 1.37m (6'3" x 4'6")	1.83m x 0.69m (6'0" x 2'3") 1.76m x 0.69m (5'9" x 2'3")	N/A	1.80m x 1.12m (5'11" x 3'8")
36' x 12'	3	1.91m x 1.37m (6'3" x 4'6")	1.83m x 0.69m (6'0" x 2'3") 1.76m x 0.69m (5'9" x 2'3")	1.83m x 0.61m (6'0" x 2'0")	1.80m x 1.12m (5'11" x 3'8")
38' x 12'	3	1.91m x 1.37m (6'3" x 4'6")	1.83m x 0.69m (6'0" x 2'3") 1.76m x 0.69m (5'9" x 2'3")	1.83m x 0.69m (6'0" x 2'3")	1.80m x 1.12m (5'11" x 3'8")

BURGUNDY FEATURES

Along with the Swift Superior Standard (see page 4), Burgundy comes with many desirable extras including:



Sofa Bed



TV Point



Cooker



Wardrobe



Electric Fire



Lined curtains with tie backs and voiles

Contemporary electric fire



Extractor fan vented outside





FEATURES

EXTERIOR

- Fusion galvanised chassis with finish warrantied for ten years
- Bonded sandwich exterior wall construction for greater strength
- Coated steel pantile roof
- Distinctive pre-coated 'folded' steel bargeboards with LED lighting to front aspect
- 'Sandy Beige' woodgrain textured aluminium cladding
- uPVC windows with push-button security locks
- PVC gutters and down pipes
- Low energy exterior side light

INSULATION

- Excellent thermal performance:
 - 50mm insulation in floor
 - 90mm insulation in roof
 - 30mm insulation in walls
 - Lagged underfloor pipes

INTERIOR

- 'Botanical' soft furnishing scheme
- Gas water heater
- Luxury carpet with underlay throughout
- Laminate effect vinyl flooring in kitchen/dining/bathroom(s)
- Low energy LED lighting throughout
- 'Nebraksa Oak' woodgrain
- USB sockets
- Good provision of double electric sockets throughout
- Hallway door to 36ft and 38ft models

LOUNGE

- Full length window offering scenic view
- Fixed L-shape sofa with fold out occasional bed
- Coffee table
- Lined curtains with tiebacks and voiles
- Fireplace design with contemporary 2kW electric Optiflame® stove feature
- Contemporary framed wall picture

KITCHEN / DINING

- 'Shaker' style kitchen doors in 'Matt Mussel' with door knob handles and drawer cup pulls in 'Arial Pewter'
- Thetford 'Cocina' glass fronted oven, grill and electronic ignition with improved door function, higher temperatures, burner rating and heat up times
- Cooker hood with extractor fan vented outside
- 4-burner gas hob with electronic ignition
- Double door freestanding fridge freezer
- Integrated microwave oven
- Stainless steel sink/drainer
- 40mm laminate worktops with matching upstands in 'Graphite Fleetwood' finish
- Dining area with fixed style seating, freestanding table and two cylinder stools

BATHROOM(S)

- Shower cubicle with thermostatic shower in main bathroom
- LED vanity spotlights
- Dual flush WC
- Extractor fan in main bathroom

BEDROOMS

- Duvalay™ mattress to all beds with Crib 5 rated fabric
- One bed stores under the other for extra space in one twin bedroom
- 'Nebraksa Oak' headboard(s)
- Bedside shelf units and overbed storage
- Vanity area with mirror and socket
- TV sockets & Co-Ax to all bedrooms plus booster (except 29' x 12' 2B)

OPTIONS

- 'Thermaglas' uPVC double glazing
- 'Front Aspect' French doors (only on double glazed models)
- Environmental exterior
- Condensing gas combi-boiler central heating and hot water system:
 - Radiator thermostats
 - Radiator in ensuite
- 'SwiftShield' stain resistant fabric
- Electric plinth heaters and towel rails
- Wireless programmable room thermostat with gas central heating
- Shaving socket in bathroom
- Bluetooth audio connection to lounge ceiling speakers
- Freestanding dining table and freestanding chairs

FLOORPLANS



29' x 12' - 2 Bedroom

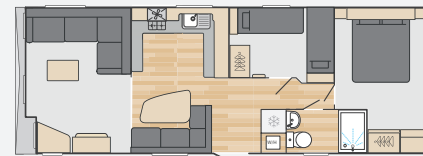

33' x 12' - 2 Bedroom



36' x 12' - 2 Bedroom

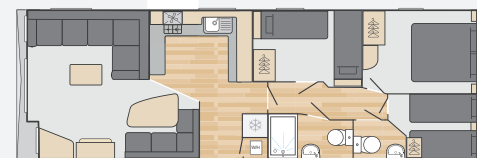

36' x 12' - 3 Bedroom

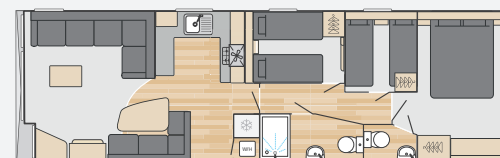

38' x 12' - 3 Bedroom



Bright, fun and functional, the Loire Holiday Home delivers stunning value with looks to match. Available in both 10ft and 12ft wide models, its large interior has a refreshing soft furnishings scheme and a choice of two or three bedrooms - everything a family needs for a relaxing holiday.

Model size	Bedrooms	Double	Twin	Rear Twin	Sofa bed
28' x 10'	2	1.91m x 1.37m (6'3" x 4'6")	1.83m x 0.61m (6'0" x 2'0") 1.76m x 0.61m (5'9" x 2'0")	N/A	1.80m x 1.12m (5'11" x 3'8")
28' x 12'	2	1.91m x 1.37m (6'3" x 4'6")	1.83m x 0.69m (6'0" x 2'3") 1.76m x 0.69m (5'9" x 2'3")	N/A	1.80m x 1.12m (5'11" x 3'8")
32' x 10'	2	1.91m x 1.37m (6'3" x 4'6")	1.83m x 0.69m (6'0" x 2'3") 1.76m x 0.69m (5'9" x 2'3")	N/A	1.80m x 1.12m (5'11" x 3'8")
32' x 12'	2	1.91m x 1.37m (6'3" x 4'6")	1.83m x 0.69m (6'0" x 2'3") 1.76m x 0.69m (5'9" x 2'3")	N/A	1.80m x 1.12m (5'11" x 3'8")
35' x 12'	2	1.91m x 1.37m (6'3" x 4'6")	1.83m x 0.69m (6'0" x 2'3") 1.76m x 0.69m (5'9" x 2'3")	N/A	1.80m x 1.12m (5'11" x 3'8")
35' x 12'	3	1.91m x 1.37m (6'3" x 4'6")	1.83m x 0.69m (6'0" x 2'3") 1.76m x 0.69m (5'9" x 2'3")	1.83m x 0.61m (6'0" x 2'0")	1.80m x 1.12m (5'11" x 3'8")
38' x 12'	3	1.91m x 1.37m (6'3" x 4'6")	1.83m x 0.69m (6'0" x 2'3") 1.76m x 0.69m (5'9" x 2'3")	1.83m x 0.61m (6'0" x 2'0")	1.80m x 1.12m (5'11" x 3'8")

LOIRE FEATURES

Along with the Swift Superior Standard (see page 4), Loire comes with many desirable extras including:



Sofa Bed



TV Point



Cooker



Wardrobe



L-shaped sofa with fold out bed

Luxury carpet with underlay



Extractor fan vented outside





Vanity area with mirror

Duvalay mattresses on all beds

FEATURES

EXTERIOR

- Fusion galvanised chassis with finish warranted for ten years
- Bonded sandwich exterior wall construction for greater strength
- Coated steel pantile roof
- Distinctive pre-coated 'folded' steel bargeboards
- 'Sandy Beige' woodgrain textured aluminium cladding
- White uPVC windows with push-button security locks
- PVC gutters and down pipes
- Low energy exterior side light

INSULATION

- Excellent thermal performance:
 - 50mm insulation in floor
 - 90mm insulation in roof
 - 30mm insulation in walls
 - Lagged underfloor pipes

INTERIOR

- 'Brock' soft furnishing scheme
- Luxury carpet with underlay throughout
- Laminate effect vinyl flooring in kitchen/dining/ bathroom(s)
- Low energy LED lighting throughout
- 'Tisano Oak' woodgrain
- USB sockets
- Good provision of double electric sockets throughout
- Hallway door (35' and 38' x 12' models only)

LOUNGE

- Front bay window giving wider views and more comfortable front seating
- Fixed L-shape sofa with fold out occasional bed and loose back cushions
- Coffee table (except 10ft models)
- Lined curtains with tiebacks
- TV point with Co-Ax and 240V socket

KITCHEN / DINING

- Glass fronted oven and grill with electronic ignition
- Stainless steel cooker hood with extractor fan vented to outside
- 4-burner gas hob with electronic ignition
- Stainless steel sink/drainer
- 30mm laminate worktops with matching upstands
- Freestanding dining table with fixed style seating and two stools
- Integrated double door fridge and freezer (12' models only)
- Integrated microwave

BATHROOM(S)

- Shower cubicle with thermostatic shower in main bathroom
- LED vanity spotlights
- Dual flush WC
- Extractor fan in main bathroom

BEDROOMS

- Duvalay™ mattress to all beds with Crib 5 rated fabric
- Contemporary handleless furniture design and feature panels
- One bed stores under the other for extra space in one twin bedroom
- 'Avola' woodgrain headboard(s)
- Bedside shelf units and overbed storage
- Vanity area with mirror and socket
- TV sockets & Co-Ax to all bedrooms plus booster (except 28' x 12' 2B)

OPTIONS

- Environmental exterior
- 'Thermaglas' uPVC double glazing
- Condensing gas combi-boiler central heating and hot water system;
 - Radiator in en suite
 - Radiator thermostats
- Freestanding dining table and freestanding chairs
- 'SwiftShield' stain resistant fabric
- Electric plinth heaters and towel rails
- Wireless programmable room thermostat
- Shaving socket in bathroom
- Bluetooth audio connection to lounge ceiling speakers
- Electric fire
- Under counter fridge (10' models)

FLOORPLANS

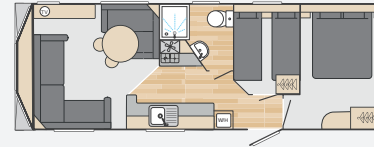

28' x 10' - 2 Bedroom



28' x 12' - 2 Bedroom

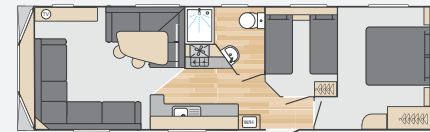

32' x 10' - 2 Bedroom

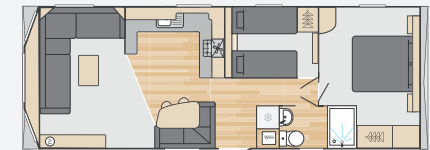

32' x 12' - 2 Bedroom

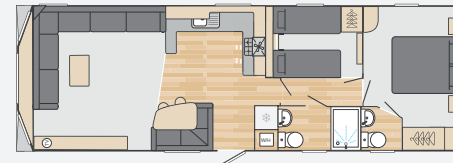

35' x 12' - 2 Bedroom

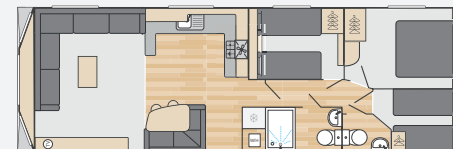

35' x 12' - 3 Bedroom

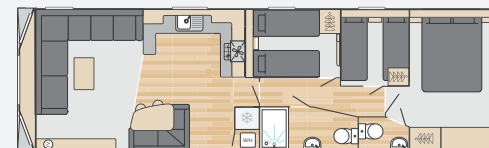

38' x 12' - 3 Bedroom



Developed for family life, the great-value Ardennes Holiday Home has a spacious, cosy atmosphere alongside easy-clean furnishings and ample storage. Combining great specification with amazing value, this holiday home is bright and hardwearing.

Model size	Bedrooms	Double	Twin	Rear Twin	Sofa bed
28' x 12'	2	1.91m x 1.37m (6'3" x 4'6")	1.83m x 0.69m (6'0" x 2'3") 1.76m x 0.69m (5'9" x 2'3")	N/A	1.80m x 1.12m (5'11" x 3'8")
32' x 12'	2	1.91m x 1.37m (6'3" x 4'6")	1.83m x 0.69m (6'0" x 2'3") 1.76m x 0.69m (5'9" x 2'3")	N/A	1.80m x 1.12m (5'11" x 3'8")
35' x 12'	2	1.91m x 1.37m (6'3" x 4'6")	1.83m x 0.69m (6'0" x 2'3") 1.76m x 0.69m (5'9" x 2'3")	N/A	1.80m x 1.12m (5'11" x 3'8")
35' x 12'	3	1.91m x 1.37m (6'3" x 4'6")	1.83m x 0.69m (6'0" x 2'3") 1.76m x 0.69m (5'9" x 2'3")	1.83m x 0.61m (6'0" x 2'0")	1.80m x 1.12m (5'11" x 3'8")
38' x 12'	2	1.91m x 1.37m (6'3" x 4'6")	1.83m x 0.69m (6'0" x 2'3") 1.76m x 0.69m (5'9" x 2'3")	N/A	1.80m x 1.12m (5'11" x 3'8")
38' x 12'	3	1.91m x 1.37m (6'3" x 4'6")	1.83m x 0.69m (6'0" x 2'3") 1.76m x 0.69m (5'9" x 2'3")	1.83m x 0.61m (6'0" x 2'0")	1.80m x 1.12m (5'11" x 3'8")
38' x 12'	2 ES	1.91m x 1.37m (6'3" x 4'6")	1.83m x 0.69m (6'0" x 2'3") 1.76m x 0.69m (5'9" x 2'3")	N/A	1.80m x 1.12m (5'11" x 3'8")

ARDENNES FEATURES

Along with the Swift Superior Standard (see page 4), Ardennes comes with many desirable extras including:

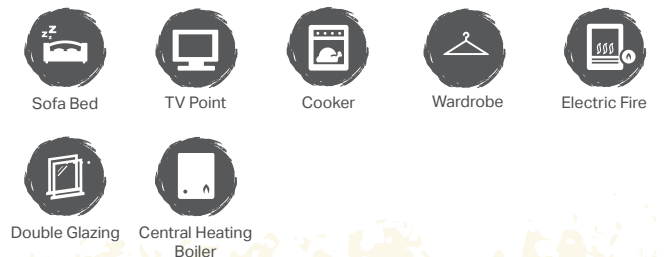



Contemporary electric fire

Luxury carpet



Low energy LED lighting



L-shape sofa with fold out occasional bed



FEATURES

EXTERIOR

- Fusion galvanised chassis with finish warranted for ten years
- Bonded sandwich exterior wall construction for greater strength
- Coated steel pantile roof
- Distinctive pre-coated 'folded' steel bargeboards with LED lighting to front aspect
- 'Sandy Beige' woodgrain textured aluminium cladding
- White uPVC windows with push-button security locks
- Black PVC gutters and down pipes
- Low energy exterior side light

INSULATION

- Excellent thermal performance:
 - 'Thermaglas' uPVC double glazing
 - 50mm insulation in floor
 - 90mm insulation in roof
 - 30mm insulation in walls
 - Lagged underfloor pipes

INTERIOR

- Condensing gas combi-boiler central heating and hot water system
- 'Opulence' soft furnishing scheme
- Radiator thermostats
- Laminate effect vinyl flooring in kitchen/dining/bathroom(s)
- Low energy LED lighting throughout
- 'Tisano Oak' woodgrain
- USB sockets
- Good provision of double electric sockets throughout
- Hallway door (except 28' x 12' model)

LOUNGE

- Full length window offering scenic view
- Fixed L-shape sofa with fold out occasional bed and loose back cushions
- Coffee table
- Lined curtains with tiebacks
- Window next to fireplace (35' & 38' x 12' models only)
- Luxury lounge carpet with underlay
- Electric fire
- Additional shelves by unit for DVD player
- TV point with Co-Ax and 240V socket

KITCHEN / DINING

- Thetford 'Cocina' glass fronted oven, grill and electronic ignition with improved door function, higher temperatures, burner rating and heat up times
- Stainless steel cooker hood with extractor fan vented to outside
- 4-burner gas hob with electronic ignition and glass splashback
- Integrated microwave oven
- Full height integrated fridge freezer
- Stainless steel sink/drainer
- 30mm 'White Ottawa' laminate worktops with matching upstands
- Freestanding dining table and chairs (two additional folding chairs in 3 bed models)

BATHROOM(S)

- Shower cubicle with thermostatic shower in main bathroom
- LED vanity spotlights
- Dual flush WC
- Radiator in en-suite
- Extractor fan in main bathroom

BEDROOMS

- Contemporary handleless furniture design and feature panels
- One bed stores under the other for extra space in one twin bedroom
- Duvalay™ mattress to all beds with Crib 5 rated fabric
- Fabric headboard(s)
- Bedside shelf units and overbed storage
- Vanity area with mirror and socket in main bedroom
- TV sockets & Co-Ax to all bedrooms plus booster (except 28' x 12' 2B)

OPTIONS

- Environmental exterior
- 'Front Aspect' French doors
- Wireless programmable room thermostat
- Shaving socket in bathroom
- Bluetooth audio connection to lounge ceiling speakers

FLOORPLANS

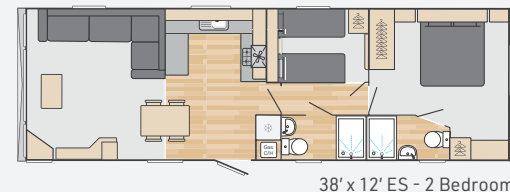
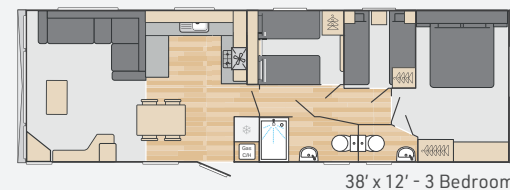
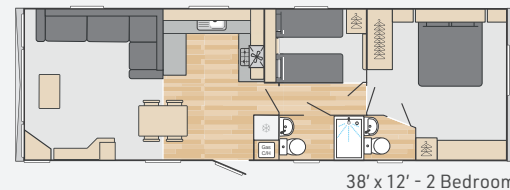
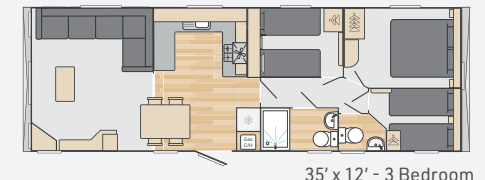
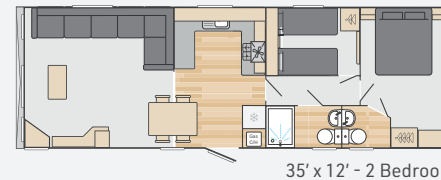
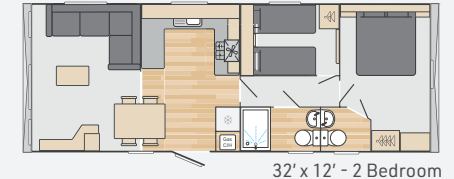
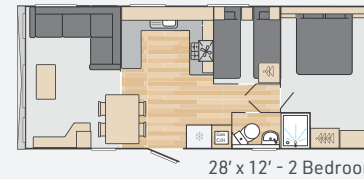

THE RANGE AT A GLANCE

	VENDEE	ANTIBES	BORDEAUX ESCAPE	BORDEAUX	BIARRITZ	BURGUNDY	LOIRE	ARDENNES
Exterior								
Fusion chassis with galvanised finish warranted for 10 years	•	•	•	•	•	•	•	•
Bonded 'sandwich' exterior wall construction	•	•	•	•	•	•	•	•
Coated steel pantile roof	•	•	•	•	•	•	•	•
Distinctive 'folded' steel bargeboards with lighting	•	•	Under canopy lighting	•	•	•	No lights	•
Woodgrain textured aluminium cladding	•	•	•	•	•	•	•	•
Patio doors	French	Optional (S)	Sliding	Optional (F)	Optional (F)	Optional (F)		Optional (F)
uPVC windows with push-button security locks	•	•	•	•	•	•	•	•
PVC gutters and down pipes	•	•	•	•	•	•	•	•
Low energy exterior light	•	•	•	•	•	•	•	•
Environmental exterior	Optional	Optional	Optional	Optional	Optional	Optional	Optional	Optional
Insulation								
'Thermaglas' uPVC double glazing	•	Optional	Optional	Optional	Optional	Optional	Optional	•
Insulation thickness in floor	50mm	50mm	50mm	50mm	50mm	50mm	50mm	50mm
Insulation thickness in roof	90mm	90mm	90mm	90mm	90mm	90mm	90mm	90mm
Insulation thickness in walls	30mm	30mm	30mm	30mm	30mm	30mm	30mm	30mm
Lagged underfloor pipes	•	•	•	•	•	•	•	•
Interior								
Condensing gas combi-boiler central heating and hot water system (GCH)	•	Optional	Optional	Optional	Optional	Optional	Optional	•
Radiator thermostats (with central heating)	•	Inc with GCH option	Inc with GCH option	Inc with GCH option	Inc with GCH option	Inc with GCH option	Inc with GCH option	•
Gas water heater		•	•	•	•	•	•	
Luxury carpet with underlay throughout	•	•	•	•	•	•	•	•
Heavy duty, durable vinyl flooring in uncarpeted rooms	•	•	•	•	•	•	•	•
Low energy LED lighting throughout	•	•	•	•	•	•	•	•
Planked interior ceiling system	•	•	•	•	•	•	•	•
USB double socket	•	•	•	•	•	•	•	•
Woodgrain	Nebraska Oak	Tisano Oak	Nebraska Oak	Nebraska Oak	Nebraska Oak	Nebraska Oak	Tisano Oak	Tisano Oak
SwiftShield stain resistant fabric	Optional	Optional	Optional	Optional	Optional	Optional	Optional	
Electric plinth heaters and electric towel rails					Optional	Optional	Optional	
Wireless programmable room thermostat with gas central heating	Optional	Optional	Optional	Optional	Optional	Optional	Optional	Optional
Lounge								
Freestanding sofas with scatter cushions	•	•	•	•				
Fixed sofas with scatter cushions					•	•	•	•
Armchair with swivel base					Except 35ft Models			
Pull-out sofa bed mechanism		•	•	•	•	•	•	•
Inflatable double bed	Optional							
2 upholstered cube stools stored under coffee table	Footstool with storage	•	•	•				
Coffee table		•	•	•	•	•	Except 10ft Models	•
Contemporary electric fire	•		•	•	Optional	•	Optional	•
Provision for Sky+ connection	•	•						
Bluetooth audio connection to lounge ceiling speaker	Optional	Optional	Optional	Optional	Optional	Optional	Optional	Optional
Framed wall pictures	1	1	1	1	Inc with optional full height partition	1		
Full height partition					Optional			

	VENDEE	ANTIBES	BORDEAUX ESCAPE	BORDEAUX	BIARRITZ	BURGUNDY	LOIRE	ARDENNES
Kitchen/dining								
Glass fronted oven and grill with electronic ignition	•	•	•	•	•	•	•	•
Stainless steel cooker hood with extractor vented to outside	•	Black angled	•	•	•	•	•	•
4-burner gas hob with electronic ignition	5-burner	•	•	•	•	•	•	•
Integrated fridge and freezer	•	•	•	•	•	•	12' models	•
Refrigerator							Optional 10' models	
Microwave oven with digital controls	•	•	•	•	•	•	•	•
'A' rated integrated 12 place setting dishwasher (if washing machine not fitted)	Optional	Optional	Optional Slimline	Optional Slimline				
Built-in washing machine with furniture door (if dishwasher not fitted)	Optional	Optional						
Stainless steel sink/drainer	White Resin Bowl & Drainer	1½ sinks	White Resin Bowl & Drainer	White Resin Bowl & Drainer	•	•	•	•
Laminate worktops with matching upstands	40mm	40mm	40mm	40mm	40mm	40mm	30mm	30mm
Soft shut drawers	•	•	•	•				
Under cupboard worktop feature lighting		•						
Fixed dinette						•	•	
Freestanding dining suite	•	•	•	•	•			•
Washrooms								
Shower cubicle with thermostatic shower in main bathroom	+ Ensuite	•	•	•	•	•	•	•
Dual flush WC	•	•	•	•	•	•	•	•
Extractor fan in main bathroom	+ Ensuite	•	•	•	•	•	•	•
Towel radiator in main bathroom	•	Inc with GCH option	Inc with GCH option	Inc with GCH option	Inc with GCH option	Inc with GCH option	Inc with GCH option	•
Radiator in en suite	•	Inc with GCH option	Inc with GCH option	Inc with GCH option	Inc with GCH option	Inc with GCH option	Inc with GCH option	•
LED vanity lighting	•	•	•	•	•	•	•	•
Shower cubicle topper	With LED light	With LED light	With LED light	With LED light	With LED light	•	•	•
Shaver socket in bathroom	Optional	Optional	Optional	Optional	Optional	Optional	Optional	Optional
Bedrooms								
King-size double bed in main bedroom (except 33' 2 bed Bordeaux and 3 bed models)	•	•		•	•			
Lift-up bed allowing easy access to storage area	•	•	•	•	•			
One bed stores under the other for extra space in one twin bedroom	Optional	Optional	Optional	Optional	Optional	•	•	•
Duvalay™ Crib 5 mattress	•	•	•	•	•	•	•	•
Padded headboard(s)	Main bed	•	•	•				
Reading lights	•	•	•	•	•			
TV sockets & Co-Ax to all bedrooms plus booster (excludes 28' x 12' models)	•	•	•	•	•	Except 29ft models	Except 28ft models	Except 28ft models
Safety								
Smoke alarm with 10-year battery	•	•	•	•	•	•	•	•
5-year carbon monoxide detectors	•	•	•	•	•	•	•	•
Fire extinguisher	•	•	•	•	•	•	•	•

THE SWIFT DIFFERENCE

As a leading manufacturer of holiday homes, touring caravans and motorhomes, we know just how to create the perfect retreat for your getaways. We apply this design and innovation excellence to all of our products, taking the time to understand what makes your breaks special and incorporating this in superb specifications, impeccable looks and creative space solutions.

Our years of experience have made the 2021 collection more diverse and impressive than ever, offering a huge choice of state of the art holiday homes for all tastes, requirements and budgets. With stylish new interior schemes and additional layouts, Swift raises the bar for leisure living.

Swift's renowned engineering and construction quality means every holiday home is built to last, and is set apart by key features like our strong, unique bonded 'sandwich' exterior walls, warrantied Fusion chassis and class-leading thermal performance. This is all wrapped up in one of the most stylish, thermally efficient and robust body structures on the market, and because we work with some of the industry's most trusted suppliers, you can be assured that everything is of the highest standard both inside and out.

CONSTRUCTION AND THERMAL EFFICIENCY

Swift's design team is widely recognised as one of the most innovative and creative in the industry, and we are constantly investigating new and better ways to develop our products. We have made significant construction and thermal efficiency improvements over the years, and continue to offer many unique build and engineering methods that set our holiday homes apart.

The NCC have introduced a Structural Thermal Rating Scheme for Caravan Holiday Homes built to BS EN 1647 which covers our Holiday Home range

and gives an indication of the likely thermal efficiency of the holiday home. The ratings are based on the calculated seasonal heating load per square metre of floor area, assuming the home is not used in the colder months between the beginning of December and end of February. A score between 1 and 10 is awarded with the most thermally efficient homes gaining a high numerical score. Homes with double glazing and good insulation gain the best ratings. When comparing scores, only homes of a similar size are comparable as the floor area affects the score.



DOUBLE GLAZING

In response to the demand for more energy conscious living, all ranges are available with heat reflecting 'Thermaglas' double glazing with a 16mm air space. This is fitted as standard on Vendee and Ardennes models and is optional on all other ranges.

CHASSIS

Every Swift holiday home comes with a 10-year anti-corrosion warranty. Swift is the only manufacturer specifying the Bankside Patterson I Beam, or Fusion galvanised chassis as standard on all its 2021 holiday home models. It has been created using the very latest design and technology to provide stability over the life of your home, not only protecting your investment but also offering peace of mind for years to come.

ROOF TRUSSES

For accuracy, strength and reliability, all Swift holiday homes use prefabricated roof trusses.

Hydraulic presses are used to press nail plates into the truss timbers to create the finished truss. The resulting roof strength is independently tested and meets Grade B snow loading (capable of carrying half a metre of settled snow), suitable for use in the UK and most of Europe, excluding Scandinavia and the Alps.

Once erected and secured in place, a minimum of 90mm glass wool insulation provides excellent thermal efficiency, followed by a breathable membrane and Thomas Panels plastisol tile effect roof sheets.

ENVIRONMENTAL CHAMBER TEST

Swift tests its holiday homes in an environmental chamber to optimise the heating and ventilation levels and measure thermal performance. Thermal imaging helps to ensure the products are fully designed and engineered to meet the requirements of a modern holiday home.

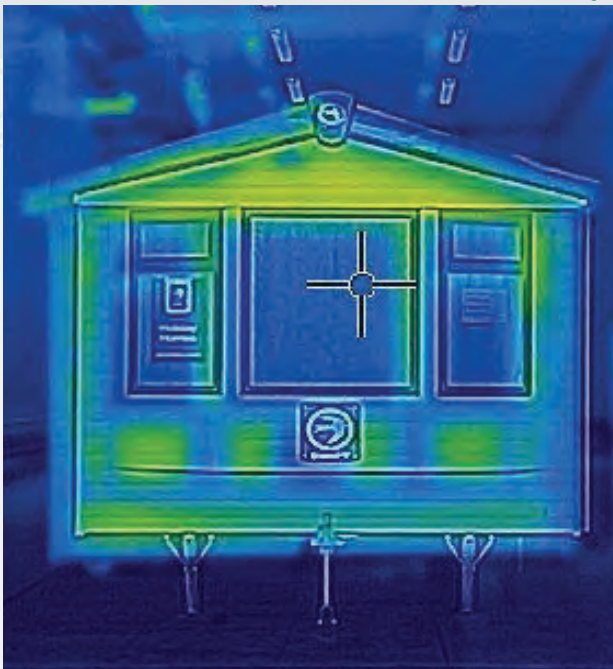

WALL CONSTRUCTION

All Swift holiday homes benefit from bonded 'sandwich' exterior wall construction for greater structural strength.

The walls are made in modules approximately 3m long and 2m high, which are securely fixed together during the holiday home's final assembly before being clad with aluminium. Each model consists of a robust timber frame, battened out and filled with an insulating layer of equal thickness. This is precision cut with water jets to eliminate air gaps or voids. On the outer surface is a breathable moisture membrane, and on the inner is a skin of plywood covered with a decorative wall covering.

These components are bonded together in the well-proven production unit, used to make similar panels for touring caravans and motorhomes. The panels act as structural members to help keep the whole home more rigid, as well as being straighter and resisting sideways deflection.

FLOOR CONSTRUCTION

In the standard Holiday Home ranges, the floor is constructed from timber joists much like a traditional home. Class-leading 50mm glass wool insulation is placed between the joists and the floor is covered with a breathable membrane. The floor surface is 18mm tongue and groove chipboard with a waterproof finish for durability.

SAFETY COMES FIRST

Your safety is paramount, and you can be assured that Swift takes this seriously. All our holiday homes are built in accordance with British and European standards EN1647 and EN1949 and are certified by the National Caravan Council (NCC).

Standard safety equipment includes a smoke alarm with a 10-year battery, carbon monoxide detectors in dining areas and hallways with a 5-year battery, and a fire extinguisher. Showers are fitted with thermostatic mixer valves to ensure a constant temperature.



DIMENSIONS

- L1** Overall length including detachable towbar
- L2** Overall length excluding detachable towbar
- L3** Body length (including bay where applicable)
- L4** Body length at floor level
- W1** Overall width including gutters and down pipes
- W2** Width at floor level
- H1** Overall height

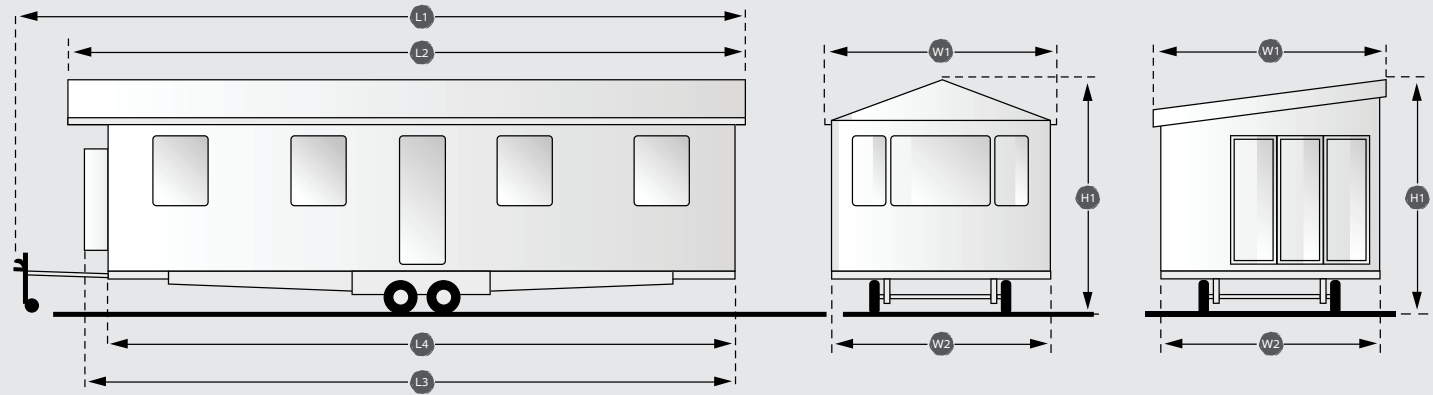

Model	L1	L2	L3	L4	W1	W2	H1
Vendee 40x12-2 bed	13.38m (43'11")	12.81m (42'0")	12.39m (40'8")	12.39m (40'8")	3.96m (13'0")	3.70m (12'2")	3.62m (11'11")
Antibes 39x12-2 bed	12.90m (42'4")	12.30m (40'4")	11.89m (39'0")	11.88m (39'0")	3.96m (13'0")	3.70m (12'2")	3.62m (11'11")
Antibes 40x12-3 bed	13.38m (43'11")	12.60m (41'4")	12.39m (40'8")	12.25m (42'2")	3.96m (13'0")	3.70m (12'2")	3.62m (11'11")
Bordeaux Escape 38x12-2 bed	12.90m (42'2")	11.87m (38'11")	10.09m (33'1")	10.09m (33'1")	3.96m (13'0")	3.70m (12'2")	3.62m (11'11")
Bordeaux Escape 41x12-3 bed	13.51m (44'4")	12.72m (41'9")	10.93m (35'10")	10.93m (35'10")	3.96m (13'0")	3.70m (12'2")	3.62m (11'11")
Bordeaux 33x12-2 bed	11.53m (37'10")	10.50m (34'5")	10.09m (33'1")	10.09m (33'1")	3.96m (13'0")	3.70m (12'2")	3.62m (11'11")
Bordeaux 35x12-2 bed	11.55m (37'11")	11.35m (37'3")	10.93m (35'10")	10.93m (35'10")	3.96m (13'0")	3.70m (12'2")	3.62m (11'11")
Bordeaux 38x12-2 bed	12.90m (42'2")	12.15m (39'11")	11.75m (38'7")	11.75m (38'7")	3.96m (13'0")	3.70m (12'2")	3.62m (11'11")
Bordeaux 38x12-2 bed ES	12.90m (42'2")	12.15m (39'11")	11.75m (38'7")	11.75m (38'7")	3.96m (13'0")	3.70m (12'2")	3.62m (11'11")
Bordeaux 38x12-3 bed	12.90m (42'2")	12.15m (39'11")	11.75m (38'7")	11.75m (38'7")	3.96m (13'0")	3.70m (12'2")	3.62m (11'11")
Biarritz 35x12-2 bed	11.55m (37'11")	11.35m (37'3")	10.93m (35'10")	10.93m (35'10")	3.96m (13'0")	3.70m (12'2")	3.62m (11'11")
Biarritz 38x12-2 bed	12.90m (42'2")	12.15m (39'11")	11.75m (38'7")	11.75m (38'7")	3.96m (13'0")	3.70m (12'2")	3.62m (11'11")
Biarritz 38x12-3 bed ET	12.90m (42'2")	12.15m (39'11")	11.75m (38'7")	11.75m (38'7")	3.96m (13'0")	3.70m (12'2")	3.62m (11'11")
Burgundy 29x12-2 bed	9.78m (32'1")	9.32m (30'7")	8.90m (29'2")	8.90m (29'2")	3.96m (13'0")	3.70m (12'2")	3.41m (11'2")
Burgundy 33x12-2 bed	10.92m (35'10")	10.46m (34'4")	10.05m (33'0")	10.05m (33'0")	3.96m (13'0")	3.70m (12'2")	3.41m (11'2")
Burgundy 36x12-2 bed	12.08m (39'7")	11.62m (38'1")	11.20m (36'9")	11.20m (36'9")	3.96m (13'0")	3.70m (12'2")	3.41m (11'2")
Burgundy 36x12-3 bed	12.08m (39'7")	11.62m (38'1")	11.20m (36'9")	11.20m (36'9")	3.96m (13'0")	3.70m (12'2")	3.41m (11'2")
Burgundy 38x12-3 bed	12.57m (41'3")	12.12m (39'9")	11.72m (38'5")	11.45m (37'7")	3.96m (13'0")	3.70m (12'2")	3.41m (11'2")
Loire 28x10-2 bed	9.25m (30'4")	9.10m (29'10")	8.87m (29'1")	8.63m (28'4")	3.35m (11'0")	3.05m (10'0")	3.29m (10'10")
Loire 28x12-2 bed	9.25m (30'4")	9.10m (29'10")	8.87m (29'1")	8.63m (28'4")	3.96m (13'0")	3.70m (12'2")	3.41m (11'2")
Loire 32x10-2 bed	10.39m (34'1")	10.25m (33'7")	10.05m (33'0")	9.77m (32'1")	3.35m (11'0")	3.05m (10'0")	3.29m (10'10")
Loire 32x12-2 bed	10.39m (34'1")	10.25m (33'7")	10.05m (33'0")	9.77m (32'1")	3.96m (13'0")	3.70m (12'2")	3.41m (11'2")
Loire 35x12-2 bed	11.55m (37'11")	11.40m (37'5")	11.21m (36'9")	10.94m (35'11")	3.96m (13'0")	3.70m (12'2")	3.41m (11'2")
Loire 35x12-3 bed	11.55m (37'11")	11.40m (37'5")	11.21m (36'9")	10.94m (35'11")	3.96m (13'0")	3.70m (12'2")	3.41m (11'2")
Loire 38x12-3 bed	12.54m (41'2") Est	12.20m (40'0") Est	12.00m (39'5") Est	11.73m (38'6") Est	3.96m (13'0")	3.70m (12'2")	3.41m (11'2")
Ardennes 28x12-2 bed	9.60m (31'6")	9.14m (30'0")	8.72m (28'7")	8.72m (28'7")	3.96m (13'0")	3.70m (12'2")	3.41m (11'2")
Ardennes 32x12-2 bed	10.67m (35'0")	10.21m (33'6")	9.79m (32'1")	9.79m (32'1")	3.96m (13'0")	3.70m (12'2")	3.41m (11'2")
Ardennes 35x12-2 bed	11.81m (38'9")	11.35m (37'3")	10.93m (35'10")	10.93m (35'10")	3.96m (13'0")	3.70m (12'2")	3.41m (11'2")
Ardennes 35x12-3 bed	11.81m (38'9")	11.35m (37'3")	10.93m (35'10")	10.93m (35'10")	3.96m (13'0")	3.70m (12'2")	3.41m (11'2")
Ardennes 38x12-2 bed	12.61m (41'5")	12.15m (39'11")	11.75m (38'7")	11.75m (38'7")	3.96m (13'0")	3.70m (12'2")	3.41m (11'2")
Ardennes 38x12-3 bed	12.61m (41'5")	12.15m (39'11")	11.75m (38'7")	11.75m (38'7")	3.96m (13'0")	3.70m (12'2")	3.41m (11'2")
Ardennes 38x12-2 bed ES	12.61m (41'5")	12.15m (39'11")	11.75m (38'7")	11.75m (38'7")	3.96m (13'0")	3.70m (12'2")	3.41m (11'2")

SWIFT WARRANTY SCHEME

You can rest assured that your Swift holiday home comes with a comprehensive warranty, allowing you to simply relax and enjoy your home.



3-YEAR SUPERSURE WARRANTY

Your holiday home has 3-year cover for all parts and fittings (other than the structural exterior).

This includes items like:

- Freestanding furniture
- Kitchens
- Showers
- Sanitaryware
- Sockets and switches
- Interior doors and integrated furniture
- Gutter and fall pipes



5-YEAR STRUCTURAL WARRANTY

Your holiday home has a 5-year Structural Warranty and Swift will repair (or, at its option, replace) any defects with the structural integrity of the home that come to light and are notified to Swift during the warranty period.

The Structural Warranty covers any defect with the seams of the home, including water ingress through any permanently sealed seam joints and also items like:

- External doors
- uPVC windows
- Roof, walls and ceilings
- Carpets



10-YEAR CHASSIS WARRANTY

Your holiday home has a fully galvanised chassis with a 10-year Chassis Warranty, subject to maintenance. Swift will repair (or, at its option, replace) any defects with the chassis that come to light during this period, but only for as long as the home belongs to its first owner.

All warranties start from the date an approved Swift Group dealer or park operator transfers the unit to its first owner and are subject to conditions, terms and exclusions. For full details see www.swiftgroup.co.uk/owners/handbooks



EXTERIOR FINISHES & SOFT FURNISHINGS

Swift holiday homes are designed for long-lasting great looks, both inside and out. The exterior is woodgrain textured aluminium cladding.

SANDY BEIGE



ENVIRONMENTAL GREEN

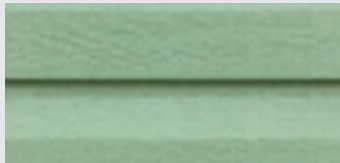

WOODGRAIN TEXTURED ALUMINIUM	SANDY BEIGE	ENVIRONMENTAL GREEN
Models		
VENDEE	•	•
ANTIBES	•	•
BORDEAUX ESCAPE	•	•
BORDEAUX	•	•
BIARRITZ	•	•
BURGUNDY	•	•
LOIRE	•	•
ARDENNES	•	•



Standard exterior finish



Optional exterior finish

40

SWIFTSHIELD

Selected Swift holiday homes are available with the exclusive option of SwiftShield fabric. SwiftShield fabric has a soft suede-type feel and has been cleverly treated during manufacturing to resist stains. It is very easy to clean and requires only a soft cloth dampened with water to remove most stains.

For full details, please go to www.swiftgroup.co.uk

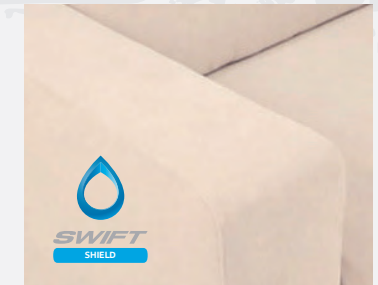

COMPARE AT A GLANCE	VENDEE	ANTIBES	BORDEAUX & BORDEAUX ESCAPE	BIARRITZ	BURGUNDY	LOIRE
SwiftShield Colour Options						
LATTE (908)	•		•	•		•
COCOA (136)				•		
STONE (960)	•			•	•	•
PEBBLE (976)		•				
DOVE (77)		•				

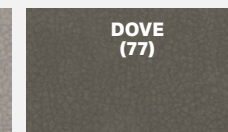
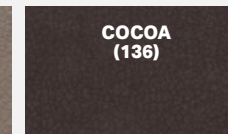
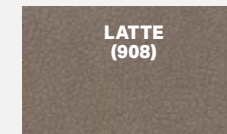



ONLY SWIFT APPROVED PARTNERS SELL APPROVED SWIFT HOLIDAY HOMES AND LODGES

Swift wants to make sure your buying experience is the best it can be. When you buy from a Swift Approved Partner, you can rest assured that your holiday home is fully supported by Swift Group and the supplying distributor.

The benefits of buying from a Swift Approved Partner include:

- Swift Group Approved Warranty
- Dealer access to Swift Connect aftersales support
- Approved spare parts
- Approved engineers
- Access to Swift Approved technical engineers
- Product on display at distributors
- Financial services to help with your purchase*

Find your nearest Swift Approved Partner from our list on the back of the brochure or the Swift Group website, www.swiftgroup.co.uk, and look out for the Swift Approved Partner signs in dealerships.

* Subject to status



Find out more at swiftgroup.co.uk



Brochures



Layouts



Dealer



Social



Make your staycation a

safe-cation





SWIFT
CREATING SMILES FOR LIFE

DEALERS

Cumbria
Kendal Caravans
Kendal
Tel: 01539 823659
kendalcaravans.co.uk

Devon
Surf Bay Leisure
Winkleigh
Tel: 01837 680100
surfbayleisure.co.uk

Dorset
Surf Bay Leisure
Bridport
Tel: 01308 427444
surfbayleisure.co.uk

Durham
Ideal Caravans
Durham
Tel: 0191 378 0146
idealcaravans.co.uk

East Midlands
Don Amott Leisure Kingdom
Derby
Tel: 01283 732193
donamottparks.com

Hampshire
PM Leisure
Hayling Island
Tel: 023 9246 7722
pmleisure.co.uk

Lancashire
Westfield Caravans
Blackpool
Tel: 01253 301505
westfieldcaravans.co.uk

Lincolnshire
Seymours Caravans
Skegness
Tel: 01754 764270
seymourscaravans.co.uk

TLC Skegness
Skegness
Tel: 01754 875050
theleisurecompany.co.uk

Norfolk
McDonnell Caravans
Kings Lynn
Tel: 01553 636243
mcdonnellcaravans.co.uk

Parklands Leisure
Wells-next-the-Sea
Tel: 01328 710166
parklandsleisure.co.uk

Pioneer Caravans
Peterborough
Tel: 01733 22244
pioneercaravans.co.uk

Northumberland
Ideal Caravans
Morpeth
Tel: 01670 515 530
idealcaravans.co.uk

Shropshire
Salop Leisure Ltd
Shrewsbury
Tel: 01743 282400
salopleisure.co.uk

Somerset
Surf Bay Leisure
Bream
Tel: 01278 751171
surfbayleisure.co.uk

Yorkshire
Bridlington Caravan Centre
Bridlington
Tel: 01262 606777
bridlingtoncaravans.com

Yorkshire Holiday Homes
Wetherby
Tel: 01937 849128
yorkshirehh.co.uk

Worcestershire
Salop Leisure
Worcester
Tel: 01299 878872
salopleisure.co.uk

Northern Ireland
Sandycove Holiday Homes
Donaghadee
Tel: 028 4275 8200
sandycove.co.uk

Hayes Caravans
Dungannon
Tel: 0288 7767575
hayescaravans.com

Ireland
Harry Farrell & Sons Ltd
Dublin
Tel: +353 (0)1 458 9410
harryfarrellsons.ie

Scotland
Swalwell Holiday Group
Gatehouse of Fleet
Tel: 01556 506 200
swalwellholidaygroup.co.uk

Dee Valley Caravans
Aberdeen
Tel: 01330 811351
deevalleycaravans.co.uk

Ideal Caravans
Adderstone (Borders)
Tel: 0191 378 0146
idealcaravans.co.uk

Wales
Blackhills Caravan Sales
Gower
Tel: 01792 851221
blackhillscaravansales.co.uk

Lloyds Caravan & Lodge Sales
Pensarn
Tel: 01654 832050
lloyds-caravans.co.uk

Lloyds Caravan & Lodge Sales
Towyn
Tel: 01745 350043
lloyds-caravans.co.uk

Salop Leisure
Machynlleth
Tel: 01654 705900
salopleisure.co.uk

Mon Caravans
Anglesey
Tel: 01407 831138
moncaravans.com



SWIFT
APPROVED PARTNER

Holland
Caravancentrum Roels
Tel: +32 (0)9 369 20 26
caravancentrumroels.be

Belgium
Caravancentrum Roels
Tel: +32 (0)9 369 20 26
caravancentrumroels.be

France
Picardy / Nord Pas de Calais
Caravancentrum Roels
Tel: +32 (0)9 369 20 26
caravancentrumroels.be

VISIT SWIFTGROUP.CO.UK

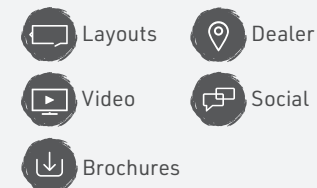

DISCLAIMER

This brochure does not constitute an offer by Swift Group Limited (Swift). Swift reserves the right to alter specifications and prices at any time as materials and conditions demand. Distributors and dealers sell Swift products on their own account and not as agents of Swift. Accordingly, they have no authority to bind Swift or to make any representation or undertaking whatsoever on behalf of Swift. All props are for photographic purposes only and are not included in the specification. Models shown may be fitted with optional extras. Issued October 2020.

CARAVANS • MOTORHOMES • HOLIDAY HOMES - MADE IN BRITAIN BY SWIFT

